

Reassembly Note:**1. Installation of the Rev Brake Arm Unit**

- (1) Before installing the Rev Brake Arm Unit, move the Idler Arm Unit aside as indicated by the arrow.
- (2) Hook the Spring of Rev Brake Arm Unit to the Hooking Portion. After hooking the Spring, confirm that Portion A of the Rev Brake Arm Unit does not pass over the Guide Pin on chassis as shown.

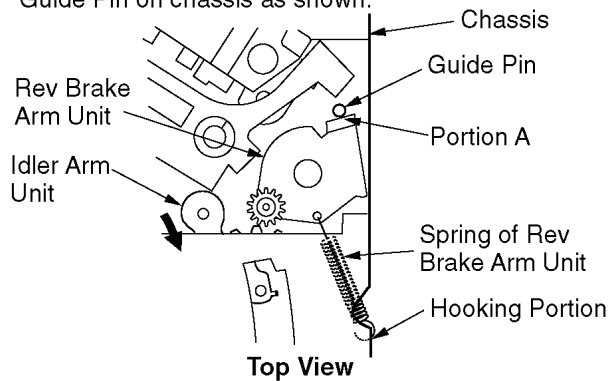

- (3) Install Cut Washer (C-1) with tweezers.

Tips on installation of the Cut Washer (C-1):

Push down one side while pushing the other side of Cut Washer.

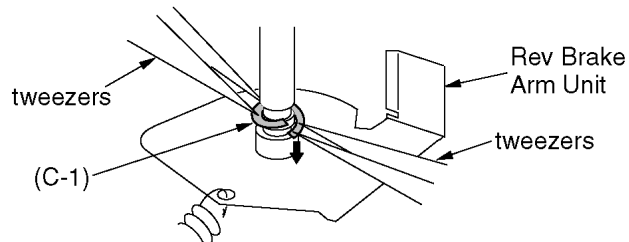

- (4) After installing, confirm that Cut Washer (C-1) can be rotated.

2. Installation of the Take Gear

- (1) Before installing the Take Gear, move the Idler Arm Unit aside as indicated by the arrow.
- (2) Install the Take Gear while rotating so it engages with Gear A so as not to cause damage. Then, confirm that Locking Tab (L-1) is set.

Note: Use extreme care when installing the Take Gear. If Locking Tab (L-1) is broken, install a new Take Gear.

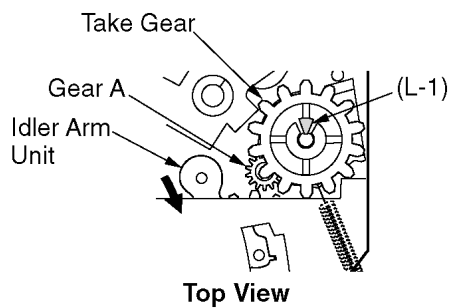
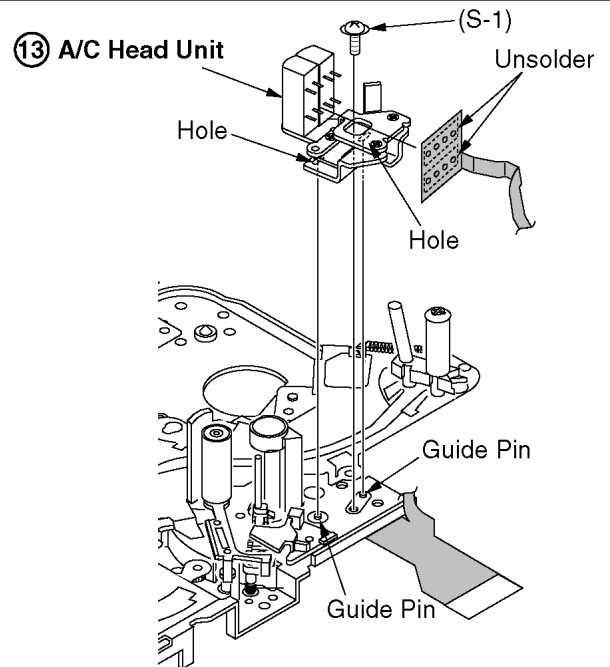

Fig. DM9-2

6.2.12. A/C Head Unit**Note:**

Unsolder under 320°C within 3 seconds.

Reassembly Note:**1. Installation of the A/C Head Unit**

- (1) Install A/C Head Unit so that 2 Guide Pins are in holes on the A/C Head Unit.
- (2) Tighten Screw (S-1) (1.0 ~ 1.3 kgf•cm) in the approximate center of the hole.

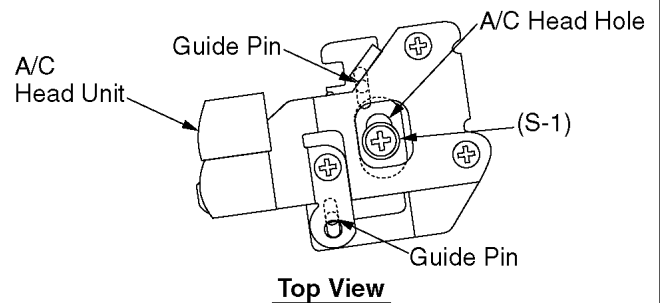
**2. Adjustment of the A/C Head Unit**

- (1) After replacing, perform the "Tape Interchangeability Adjustment" procedures.

Fig. DM10

6.2.13. Capstan Belt

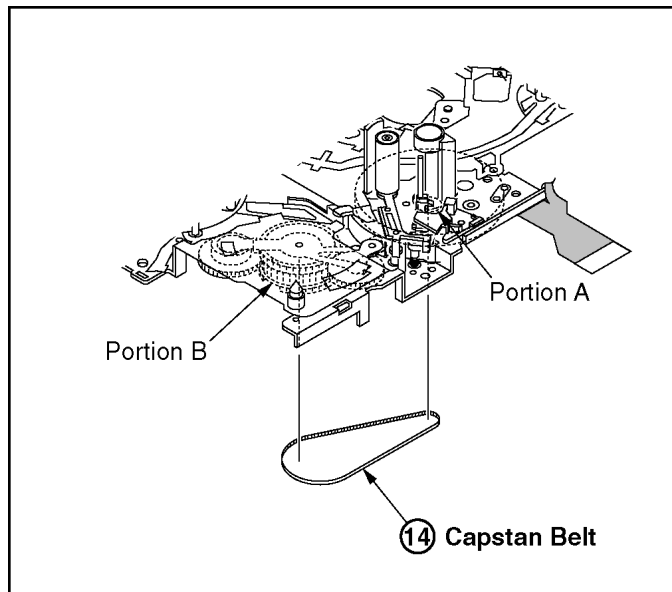

Reassembly Note:

1. Tips on Installation of the Capstan Belt

- (1) Hook the Capstan Belt to Portion A of Capstan Unit at first as shown.
- (2) Hook the Capstan Belt to Portion B of Idler Arm Unit.
- (3) Rotate the Idler Arm Unit as indicated by the arrow (counterclockwise) and set it completely.

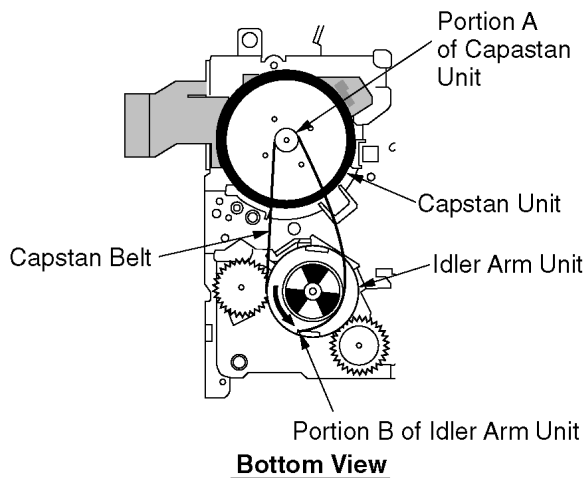
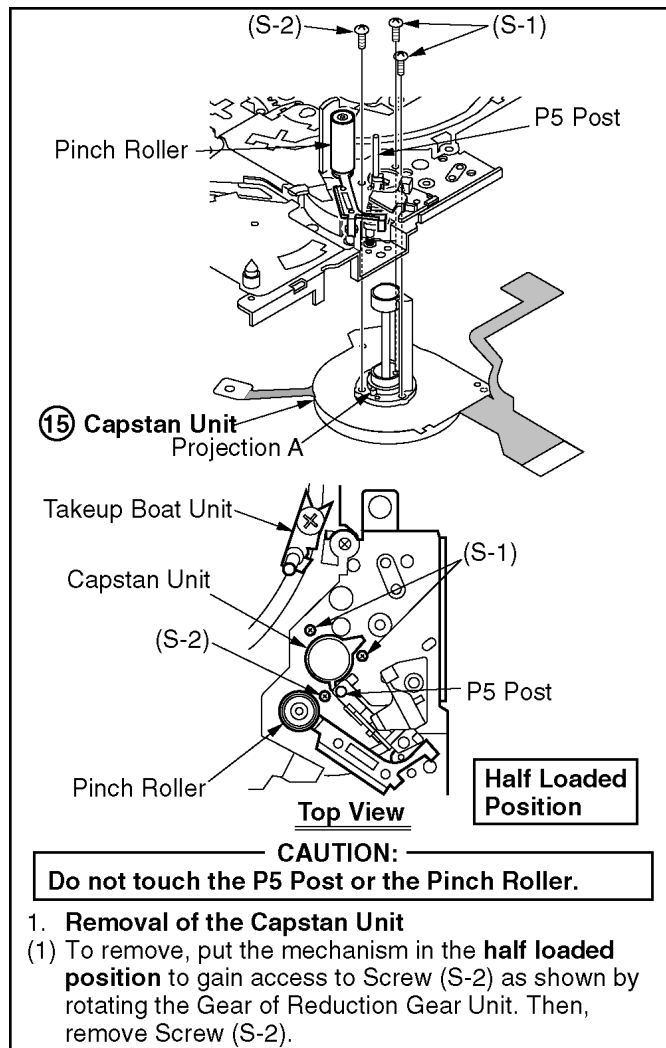

Fig. DM11

6.2.14. Capstan Unit



1. Removal of the Capstan Unit

- (1) To remove, put the mechanism in the **half loaded position** to gain access to Screw (S-2) as shown by rotating the Gear of Reduction Gear Unit. Then, remove Screw (S-2).

Reassembly Note:

1. Since the Capstan Unit has already been adjusted at the factory, do not try to adjust the FG Head. The Capstan Unit is supplied as a complete assembly as a replacement part.
2. **Installation of the Capstan Unit**
 - (1) Before installing the Capstan Unit, put the mechanism in the **half loaded position** to gain access to Screw (S-2) for installing by rotating the Gear of Reduction Gear Unit.
 - (2) Install the Capstan Unit to the Chassis so that Projection A fit in the Slot on the Chassis.
 - (3) Tighten 2 Screws (S-1). Then, tighten Screw (S-2).

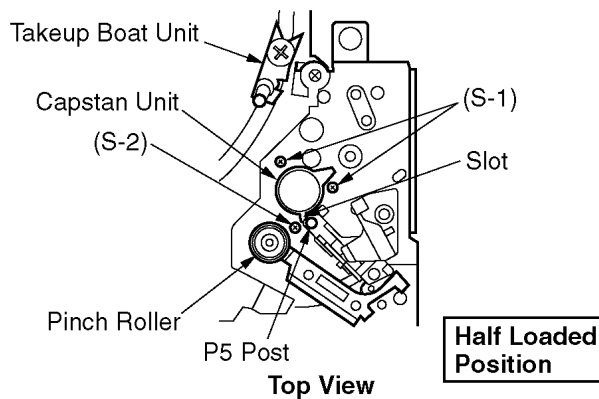
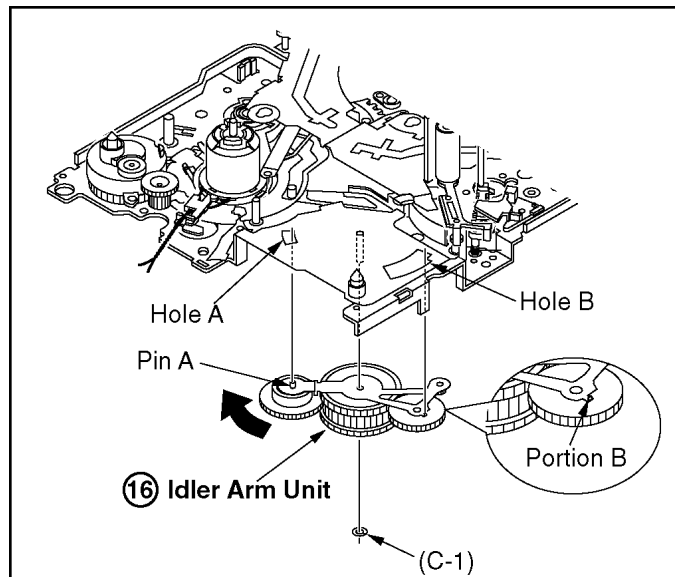

Fig. DM12

6.2.15. Idle Arm Unit



1. Removal of the Idler Arm Unit

- (1) To remove the Idler Arm Unit, pull the Idler Arm Unit slightly from the Chassis to release Pin A from Hole A. Then, remove the Idler Arm Unit while turning as indicated by the arrow.

Reassembly Note:

1. Installation of the Idler Arm Unit

- (1) Set the Idler Arm Unit so that Portion B is in Hole B as shown.
- (2) Turn the Idler Arm Unit slightly as indicated by arrow to set Pin A in Hole A.

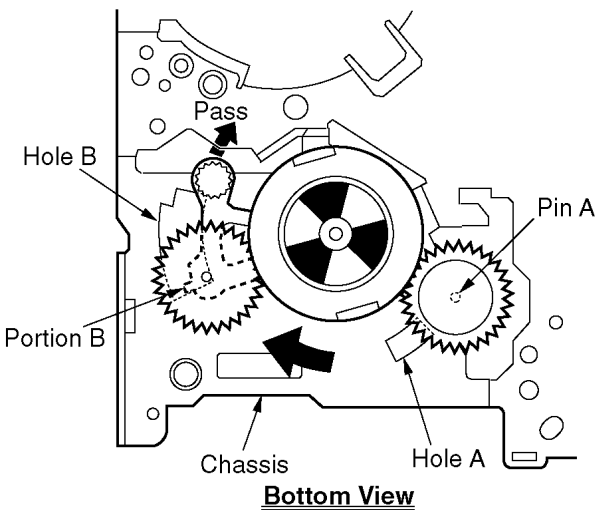

- (3) Install Cut Washer (C-1).

Fig. DM13

6.2.16. Mechanism Support Angle

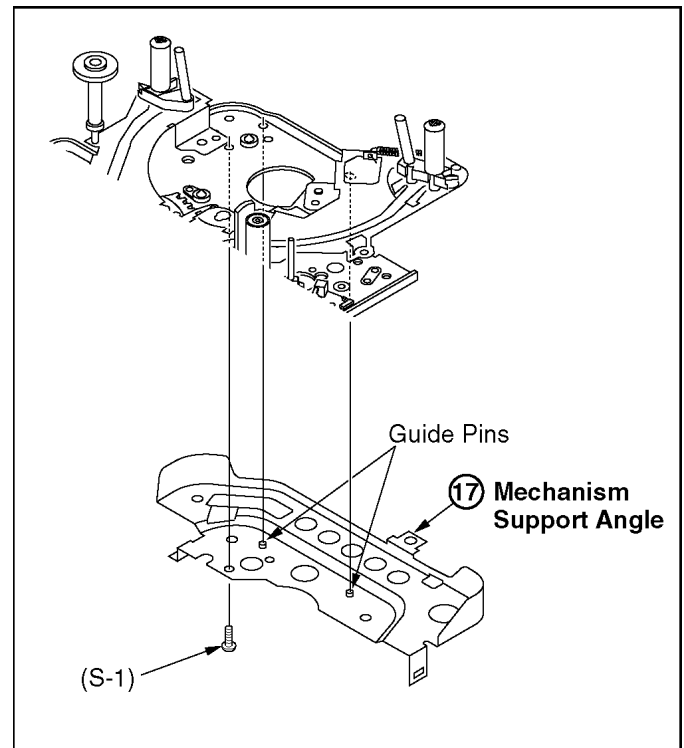
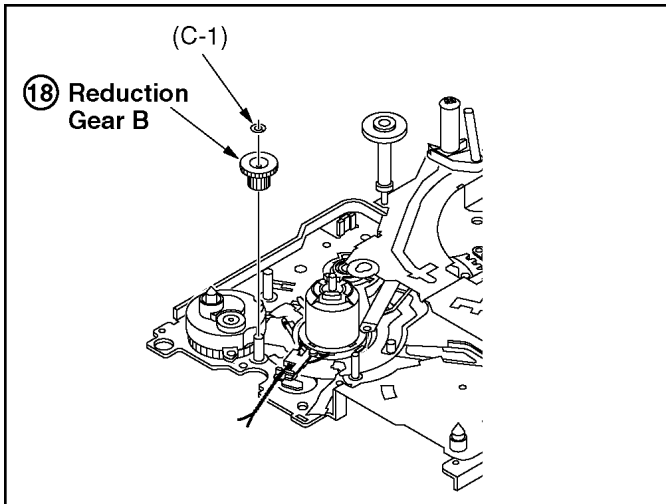

Fig. DM14

6.2.17. Reduction Gear B



Reassembly Note:

1. Installation of the Reduction Gear B

(1) Install the Reduction Gear B while rotating so it engages with the Gear of Main Cam Unit as shown.

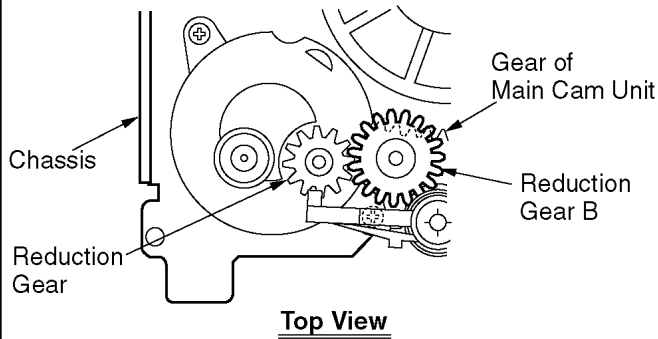

(2) Confirm that the Mechanism can be loaded or unloaded by rotating the Gear of Reduction Gear Unit.

Fig. DM15

6.2.18. Reduction Gear A, Reduction Gear Unit

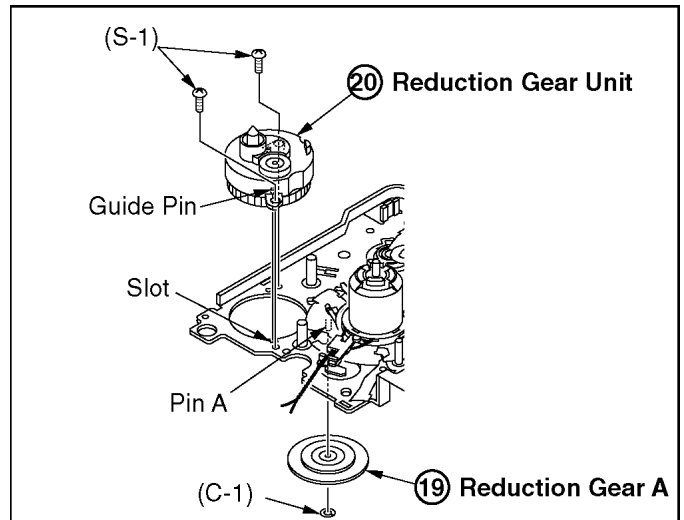

Indication on Gear of Reduction Gear Unit

The arrow indicated on the Gear of Reduction Gear Unit shows the direction to load.

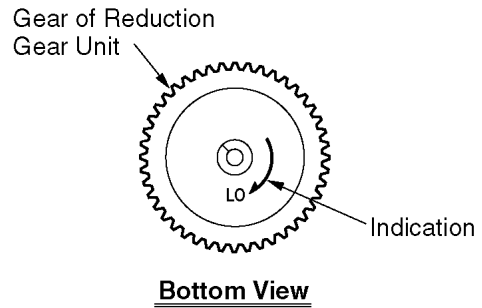

Reassembly Note:

1. Installation of the Reduction Gear Unit

(1) Install the Reduction Gear Unit so that Guide Pin fits in the Slot on the Chassis. Then, tighten 2 Screws (S-1).

Fig. DM16

6.2.19. Pinch Arm Unit, Opener, P5 Arm Unit

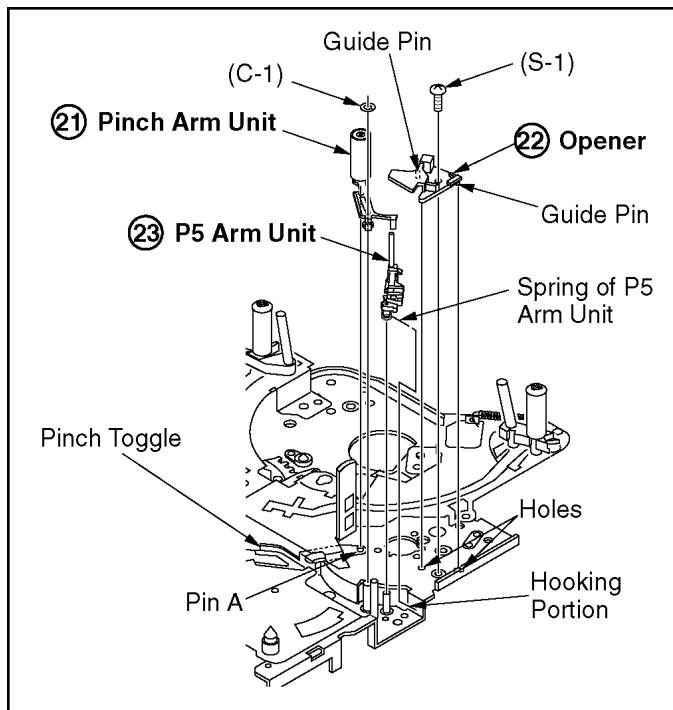
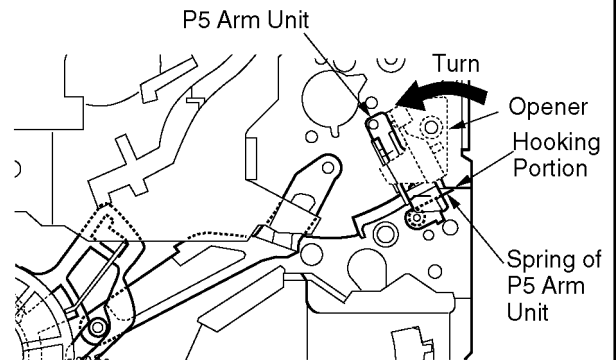

Fig. DM17-1

Reassembly Note:

1. Installation of the P5 Arm Unit and the Opener

- (1) Before installing the P5 Arm Unit, put the Mechanism in the **Loading Position** (S and T Posts are located at the end of guide slots) to make installing the Pinch Arm Unit easier. (See 2. **Installation of the Pinch Arm Unit**.)
- (2) Install the P5 Arm Unit while hooking the Spring to Hooking Portion.
- (3) Turn the P5 Arm Unit as indicated by the arrow while lifting up the P5 Arm Unit slightly from the Chassis.



Loading Position

Top View

- (4) Install the Opener so that Guide Pins on the Opener fit in Holes on the Chassis. Then, tighten Screw (S-1).
- (5) Confirm that the P5 Arm Spring is hooked on the bottom of chassis.

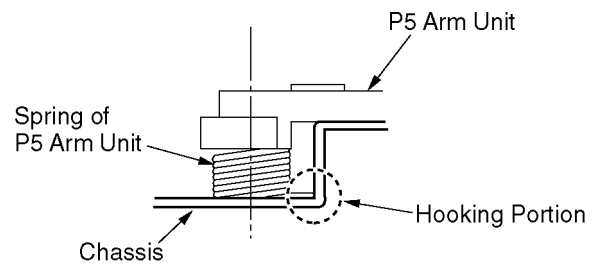

Side View

2. Installation of the Pinch Arm Unit

- (1) Install the Pinch Arm Unit.
- (2) Fit Hole A on the Pinch Arm Unit over Pin A on the Pinch Toggle as shown.

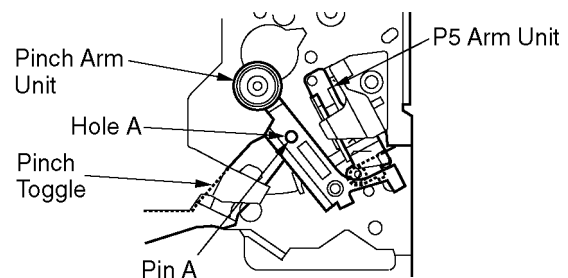

Top View

- (3) Install the Cut Washer (C-1).

3. Adjustment of the P5 Arm Unit and the Pinch Arm Unit

- (1) After replacing, perform the "Tape Interchangeability Adjustment" procedures.

Fig. DM17-2